

Division Two: Tentative 12-Month Letting List

Proposed Let Date	Project #	County	Route	Project Description
December 2013	17BP.2.R.11	Craven	SR 1630 (Hudnell Rd)	Replace Bridge #27 over Beaverdam Swamp
December 2013	17BP.2.R.21	Lenoir	SR 1913 (Elijah Loftin Rd)	Replace Bridge #162 over Branch of Mott Swamp
January 2014	B-5418	Pitt	NC 33	Replace Bridge #50 over Johnson Mill Run
January 2014	W-5202L	Pitt	NC 11/NC 903 (Memorial Dr)	Construct Right Turn Lane at Intersection with SR 1708 (Firetower Rd)
January 2014	17BP.2.R.53	Beaufort	SR 1616 (Terra Ceia Rd)	Bridge-to-Pipe Replacement of Bridge #161
February 2014	W-5202K	Lenoir	NC 11	Add Left Turn Lanes at Locations from SR 1747 (Highland Ave) to N of SR 1719 (Odham Rd)
February 2014	17BP.2.R.52	Greene	SR 1400 (Four Way Rd)	Replace Bridge #40 over Panther Swamp Creek
March 2014	BD-5102U, 17BP.2.R.51	Pitt, Greene	SR 1139 (Moye-Turnage Rd), SR 1344 (Darden Farm Rd)	Replace Bridges Pitt #69 and Greene #34 over Middle Swamp
April 2014	B-4708	Beaufort	SR 1001 (Cherry Run Rd)	Replace Bridge #5 over Aggie Run
April 2014	BD-5102Q	Beaufort	SR 1520 (Terrapin Track Rd)	Replace Bridge #297 over Hall Swamp
April 2014	W-5202E	Pitt	NC 43	Widen to 3 lanes from Blue Banks Farm Rd to SR 1212 (VOA Site C Rd)
April 2014	48102	Lenoir	SR 1548 (Hill Farm Rd)	Extend Left Turn Lane from US 70 to N of Fire Department Station 3
April 2014	49005	Lenoir	SR 2021 (Smithfield Way)	Road Extension from SR 1548 (Hill Farm Rd) to US 258
May 2014	BD-5102R	Greene	SR 1324 (Taylor Rd)	Replace Bridge #9 over Sandy Run
May 2014	17BP.2.R.57	Beaufort	SR 1520 (Terrapin Track Rd)	Bridge-to-Pipe Replacement of Bridge #119 over Beaverdam Swamp
June 2014	BD-5102S	Pitt	SR 1777 (Blackjack-Grimesland Rd)	Replace Bridge #142 over Cow Swamp
June 2014	17BP.2.P.23	Pitt	US 13/NC 11/NC 903 (Memorial Dr)	LMC Overlay on Bridge #66 over Tar River Overflow
June 2014	17BP.2.R.60	Pitt	SR 1907 (Marvin Taylor Rd)	Bridge-to-Pipe Replacement of Bridge #208 over Ditch
June 2014	W-5008	Beaufort	SR 1306 (15th St)	Widen from West of Washington St to East of Pierce St
July 2014	BD-5102T	Greene	SR 1301 (Friendship Church Rd)	Replace Bridge #8 over Sandy Run
August 2014	BD-5102W	Pitt	SR 1591 (Industrial Blvd)	Replace Bridge #431 over Parkers Creek
August 2014	BD-5102Y	Pitt	SR 1108 (Littlefield Rd)	Replace Bridge #415 over Branch of Swift Creek
September 2014	B-5129A	Pamlico	NC 304	Replace Bridge #24 over North Prong of Bay River
September 2014	BD-5102Z	Pitt	SR 1941 (Clay Root Rd)	Replace Bridge #20 over Clayroot Swamp
September 2014	BD-5102AA	Greene	SR 1240 (Walston Rd)	Replace Bridge #93 over Beaman Run
October 2014	17BP.2.R.54	Beaufort	SR 1530 (Baseline Rd)	Replace Bridge #150 over Fork Swamp Branch

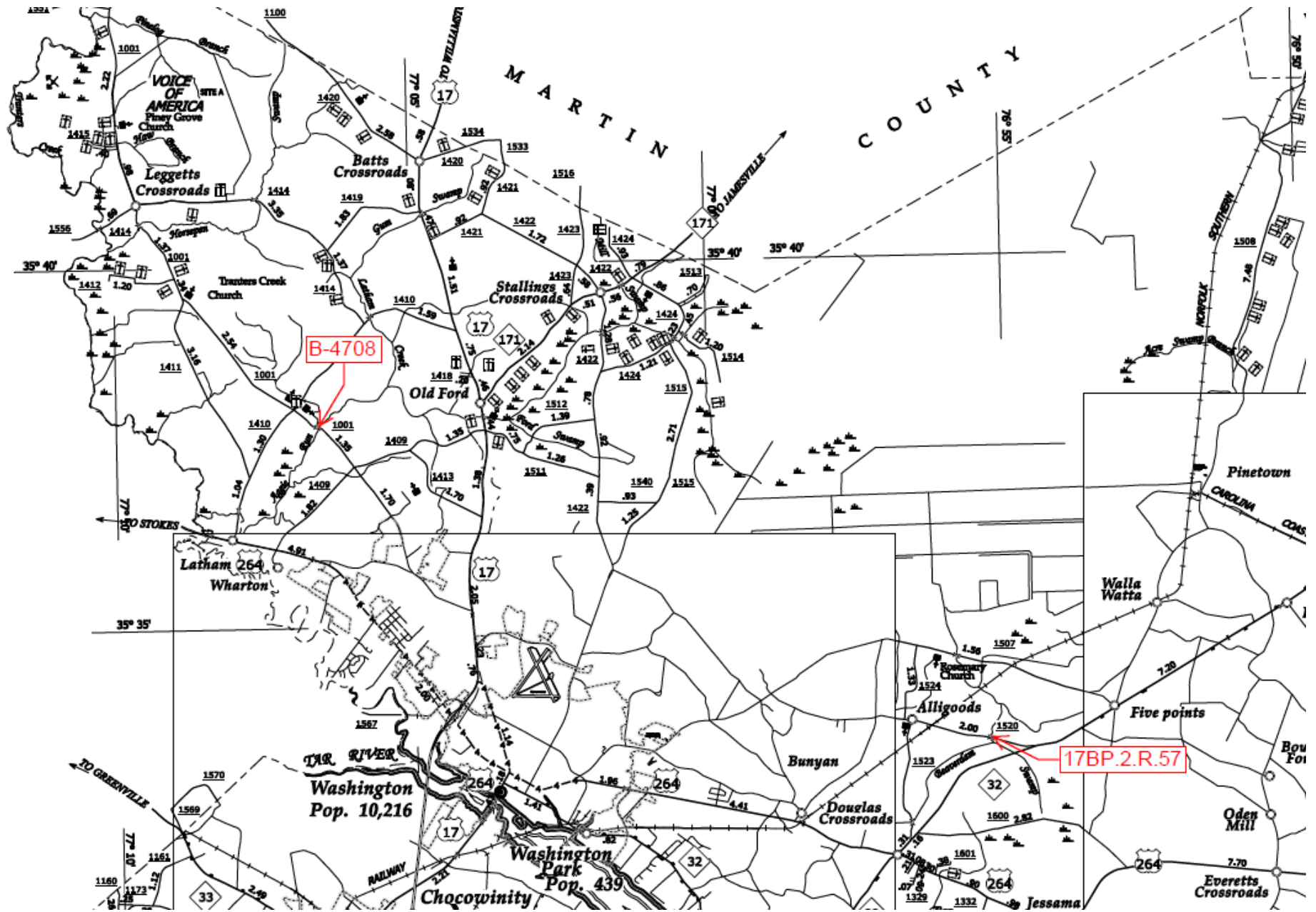

BEAUFORT COUNTY

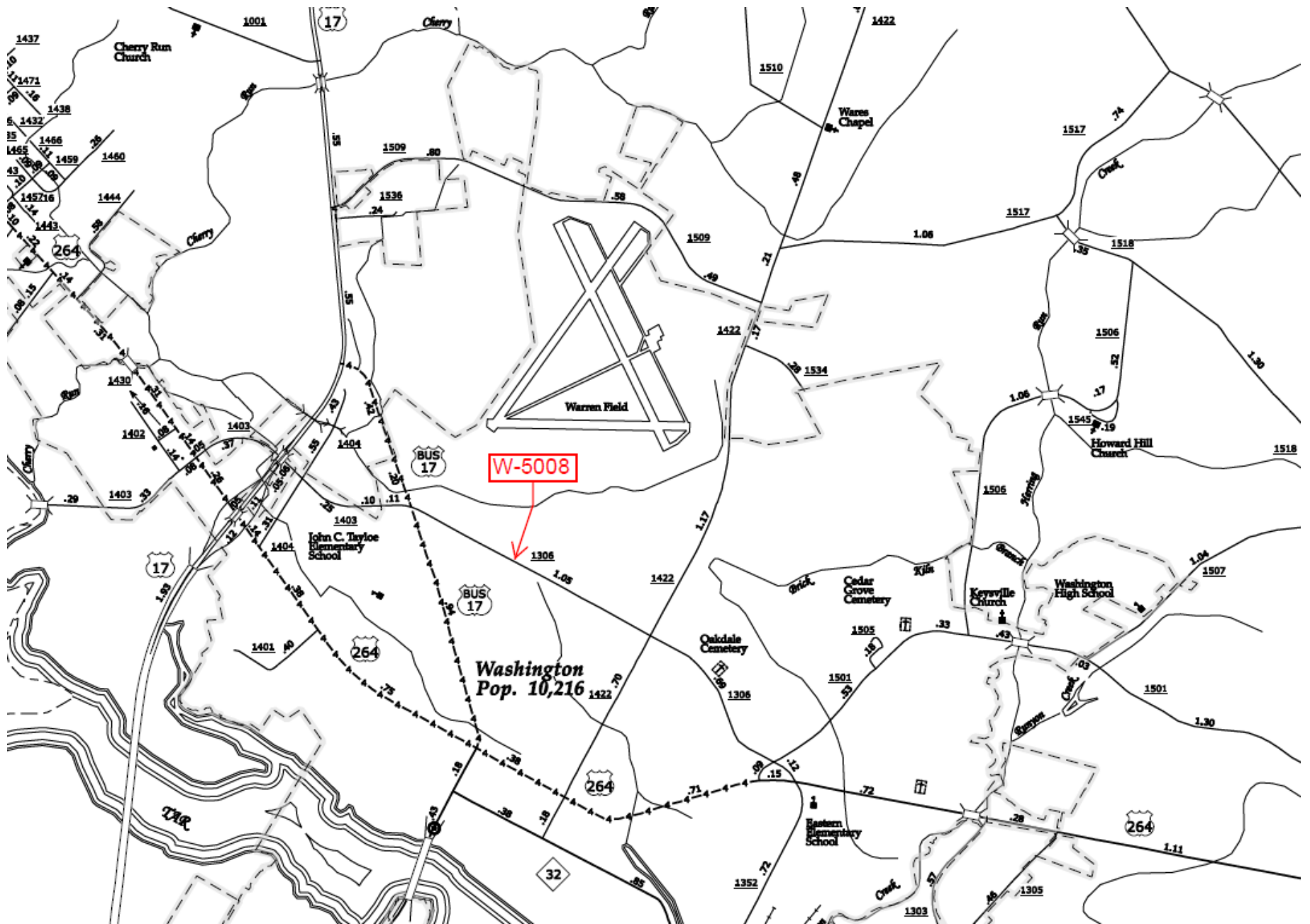

BEAUFORT COUNTY

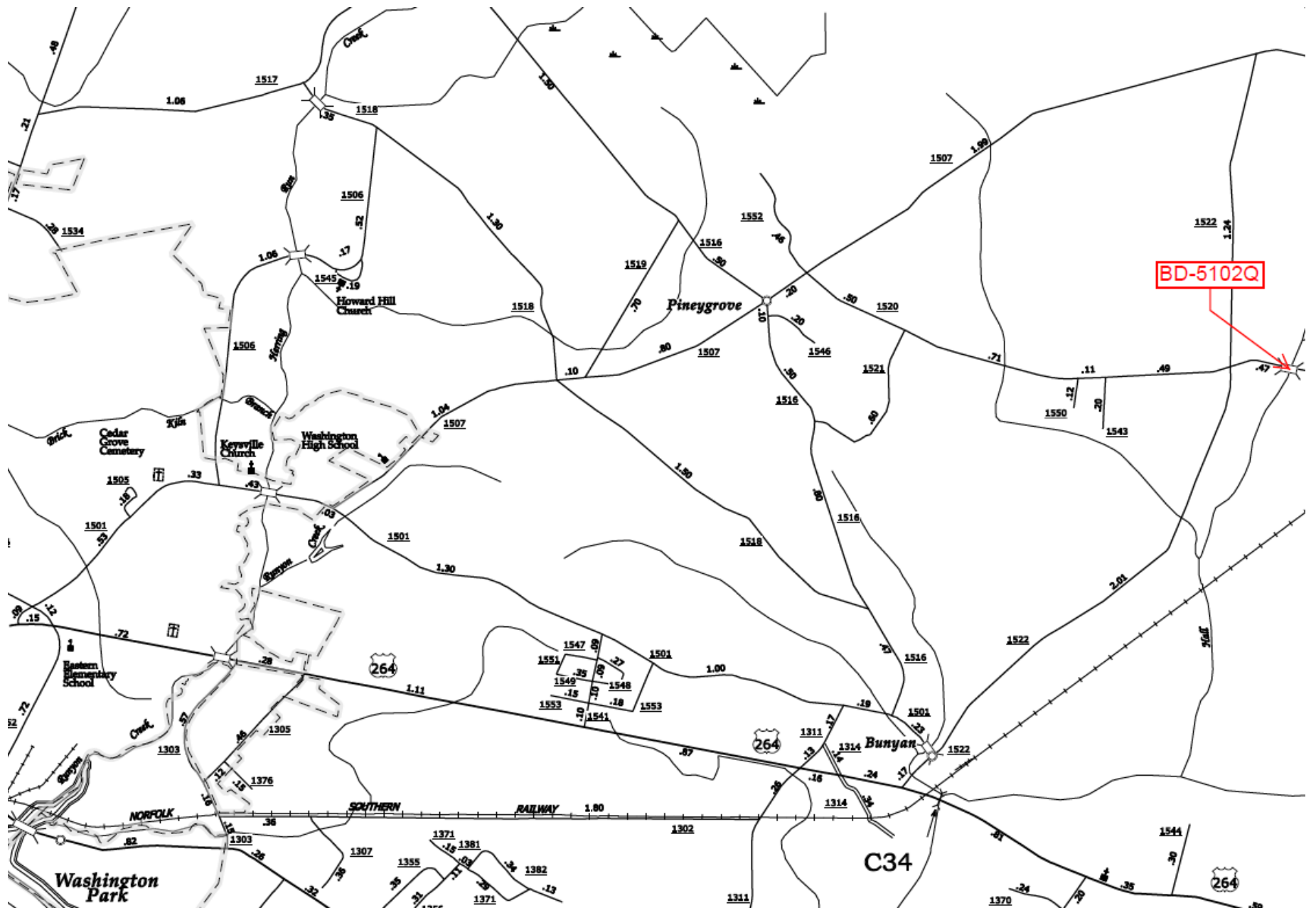

BEAUFORT COUNTY

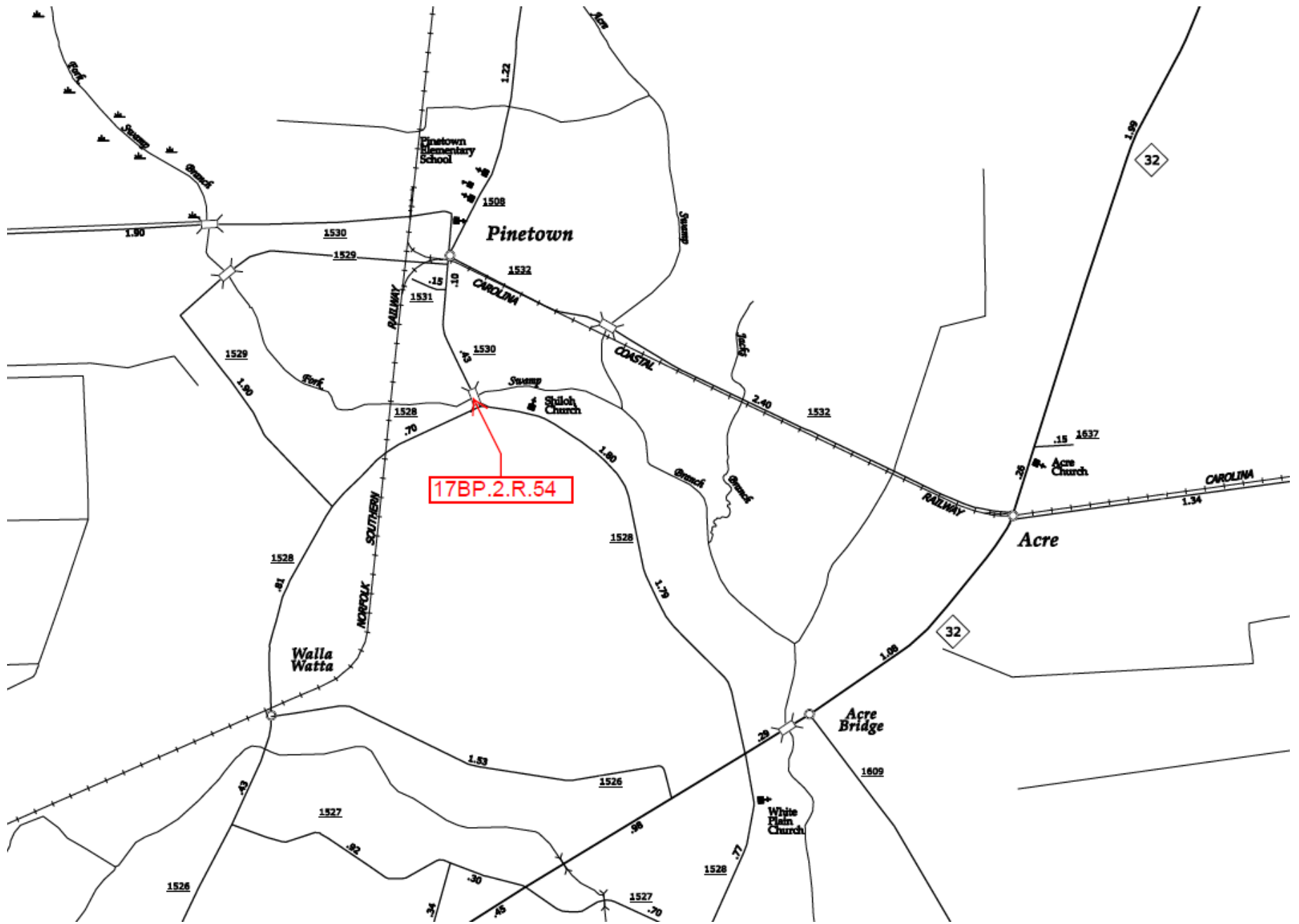

BEAUFORT COUNTY

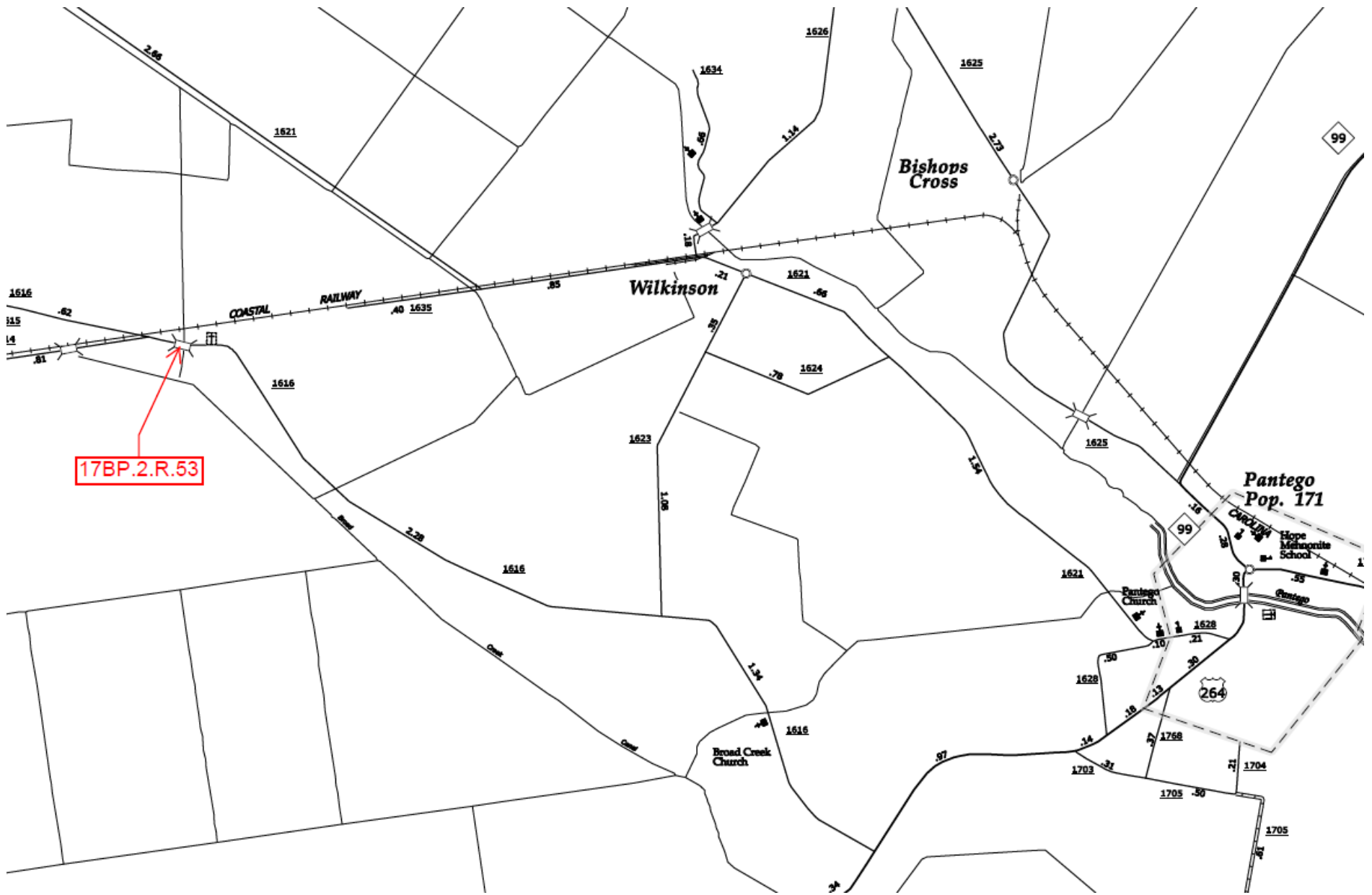

17BP.2.R.53

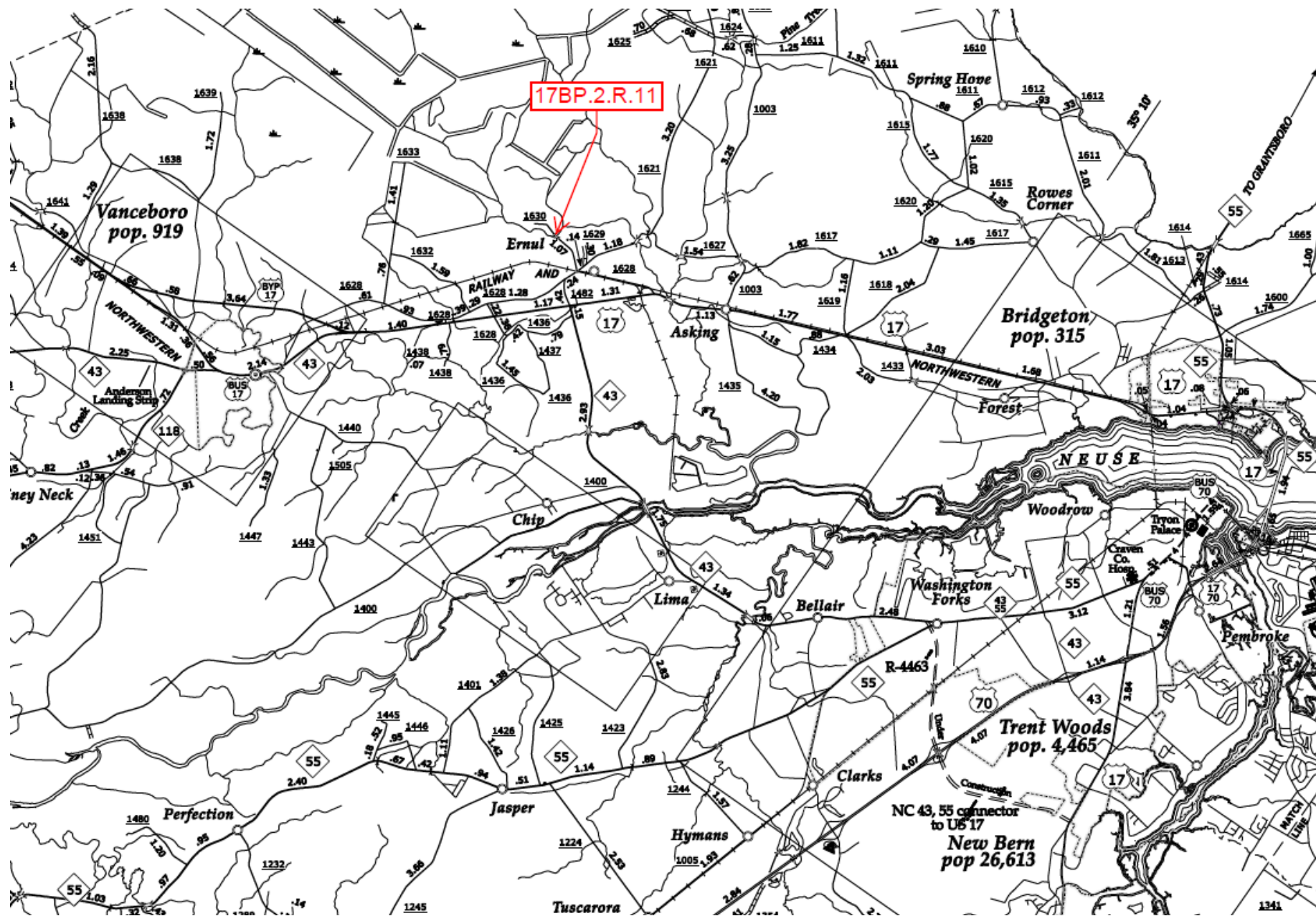

CRAVEN COUNTY

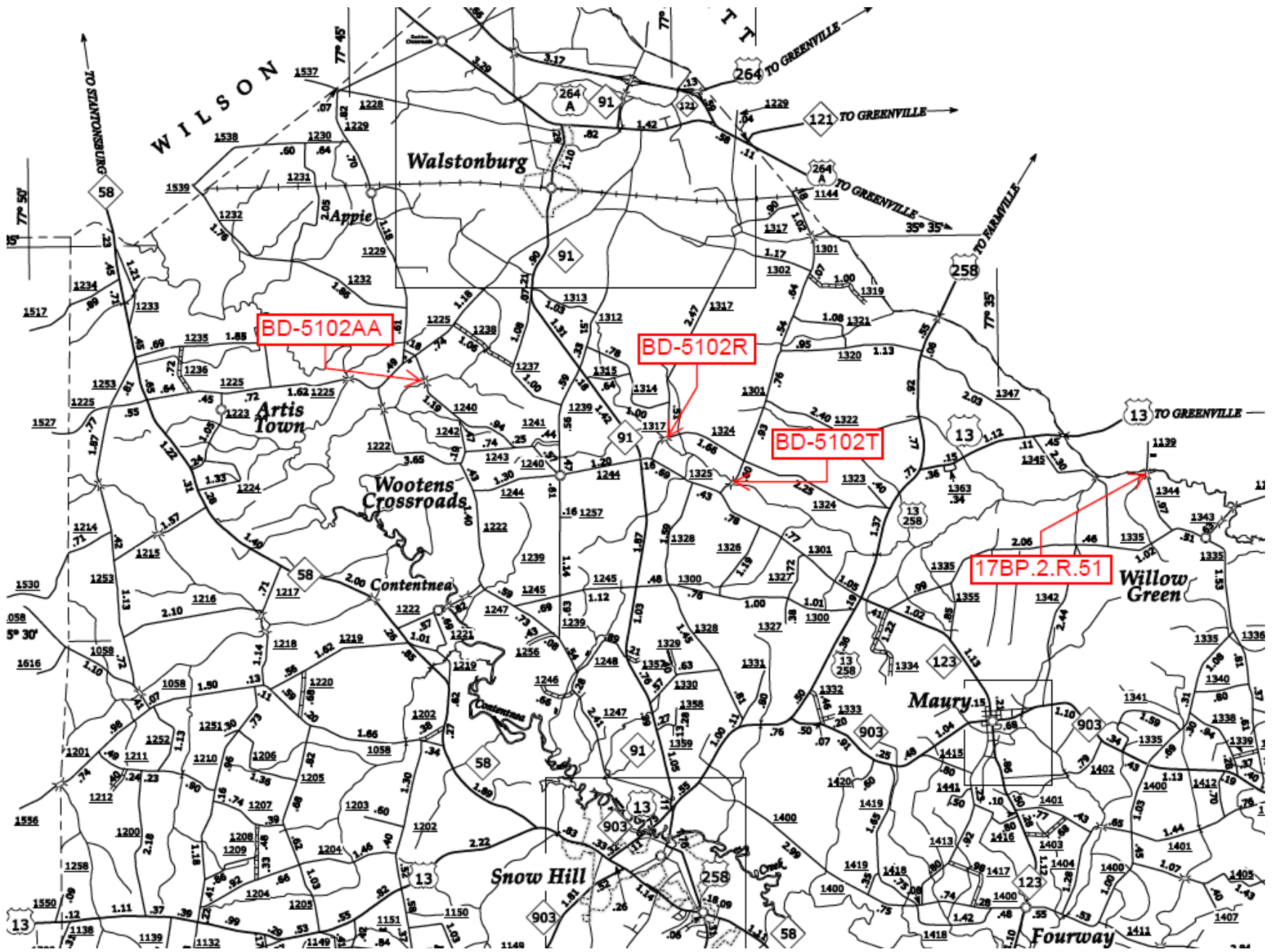

GREENE COUNTY

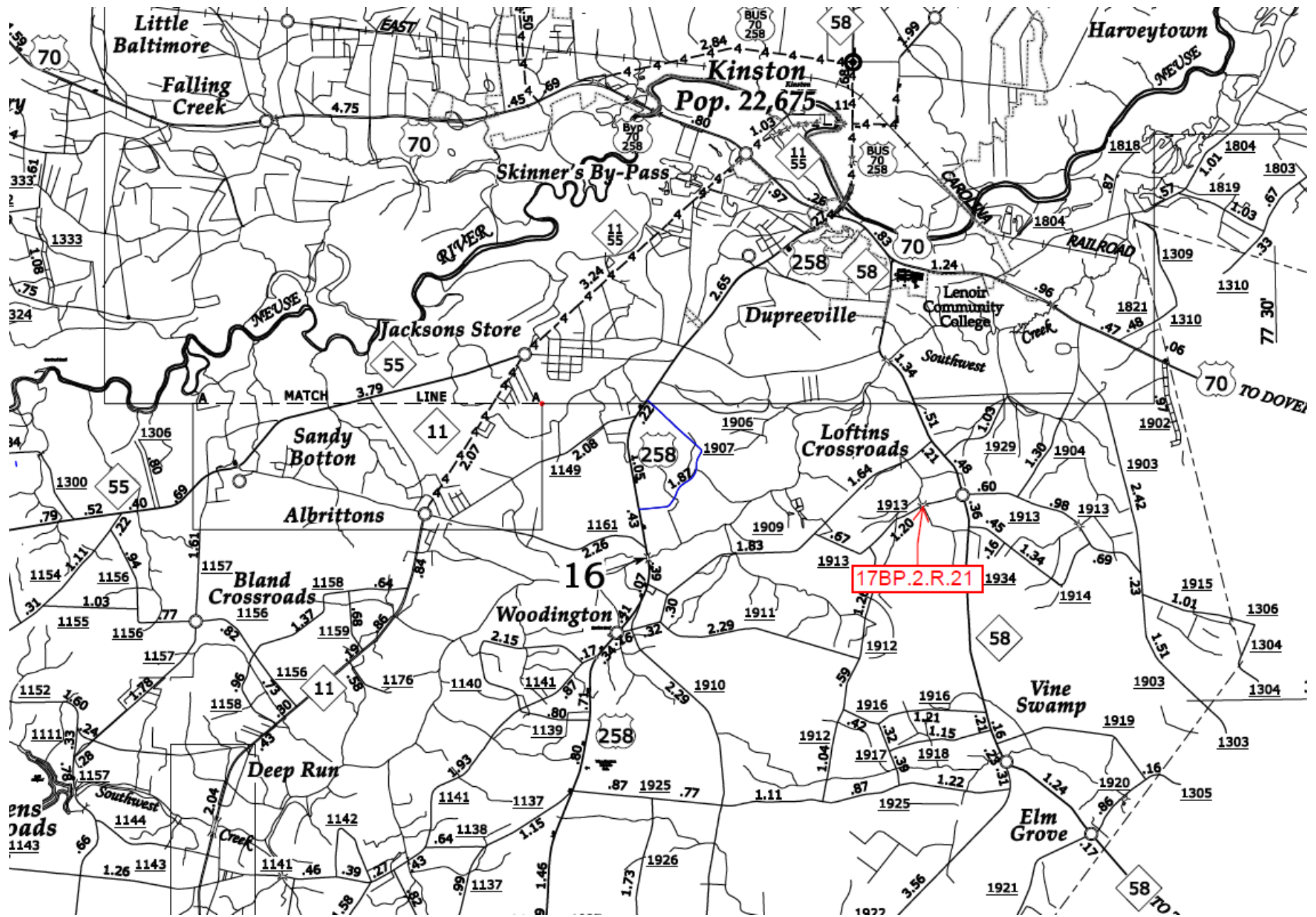

LENOIR COUNTY

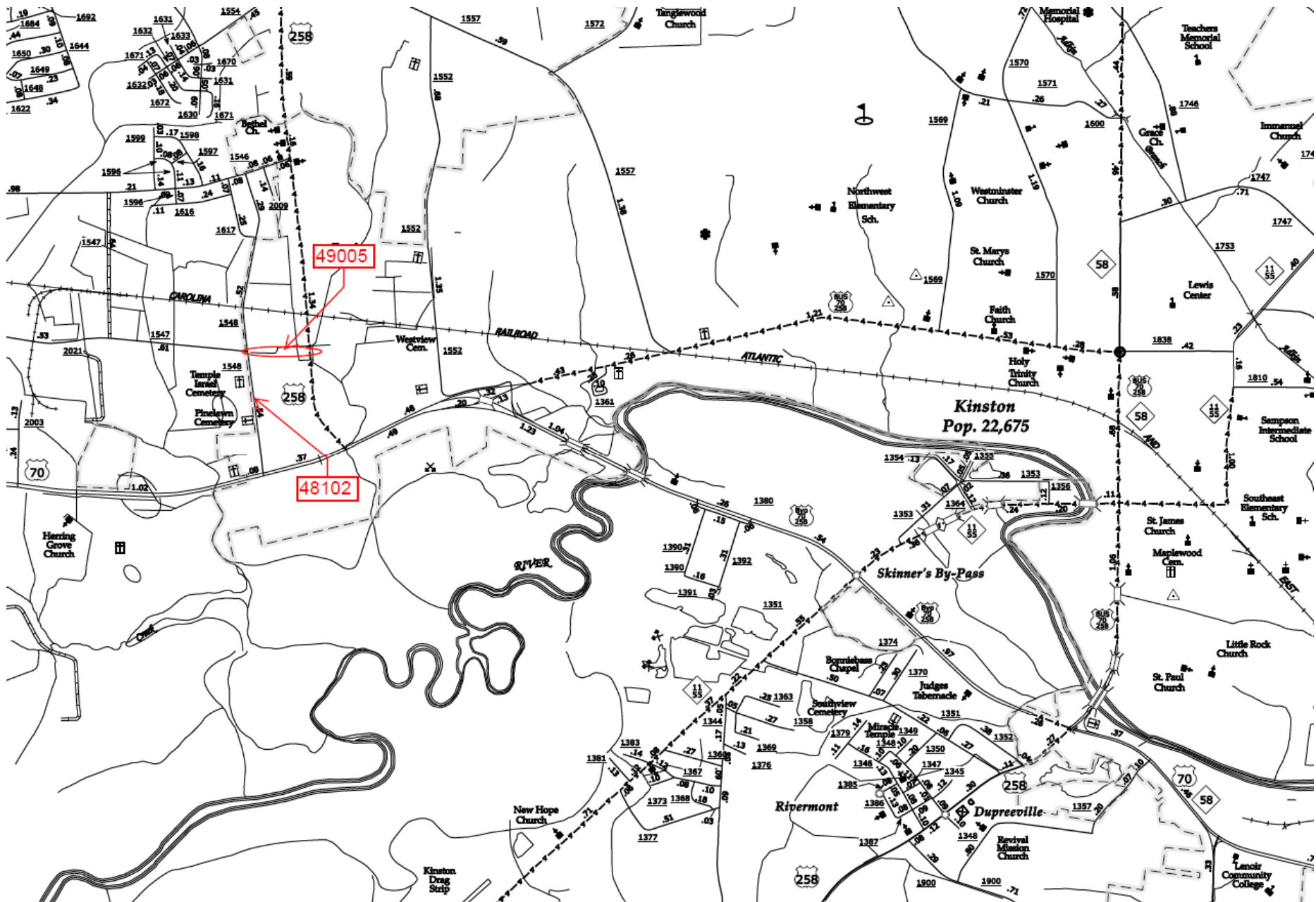

LENOIR COUNTY

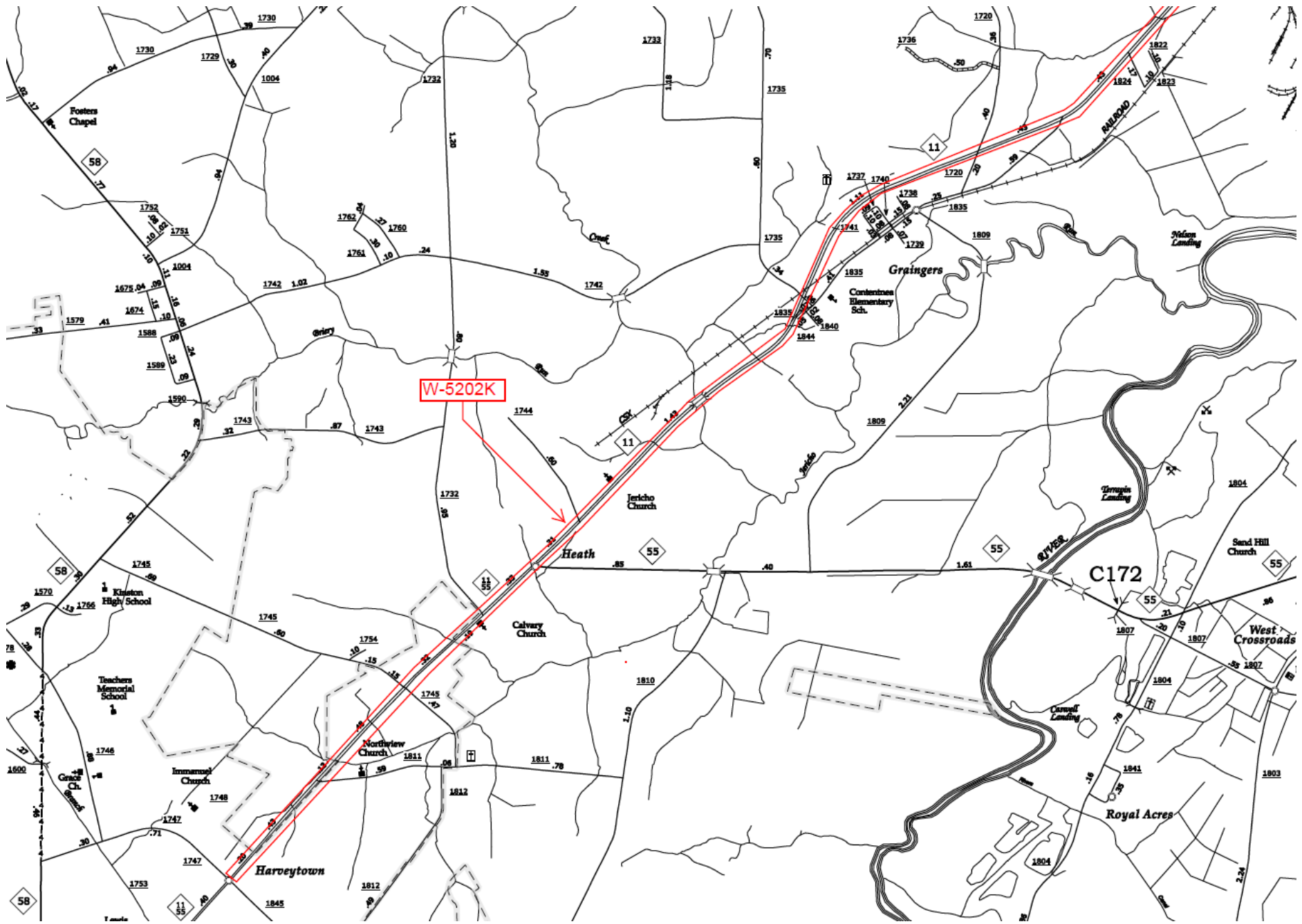

LENOIR COUNTY

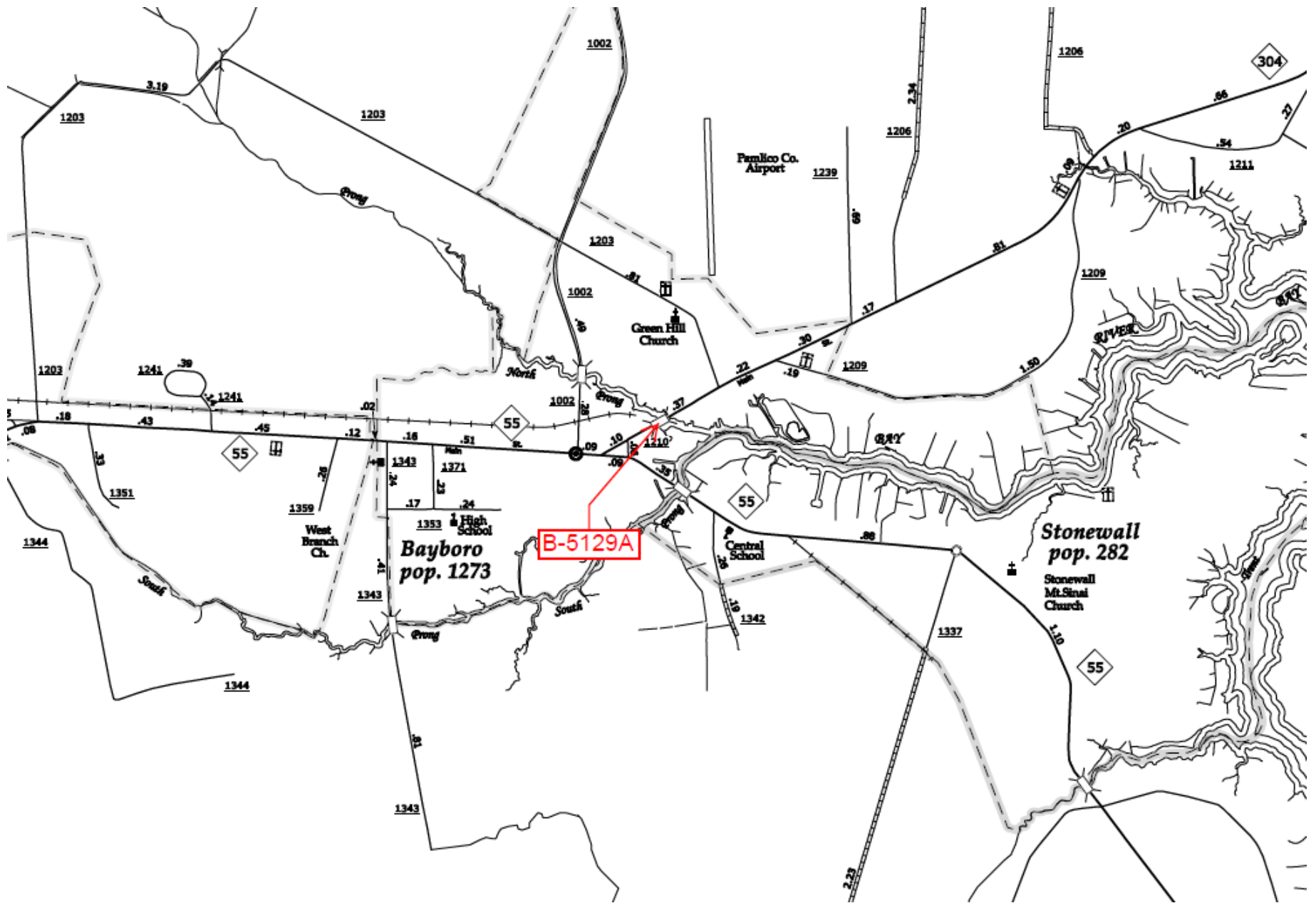

PAMLICO COUNTY

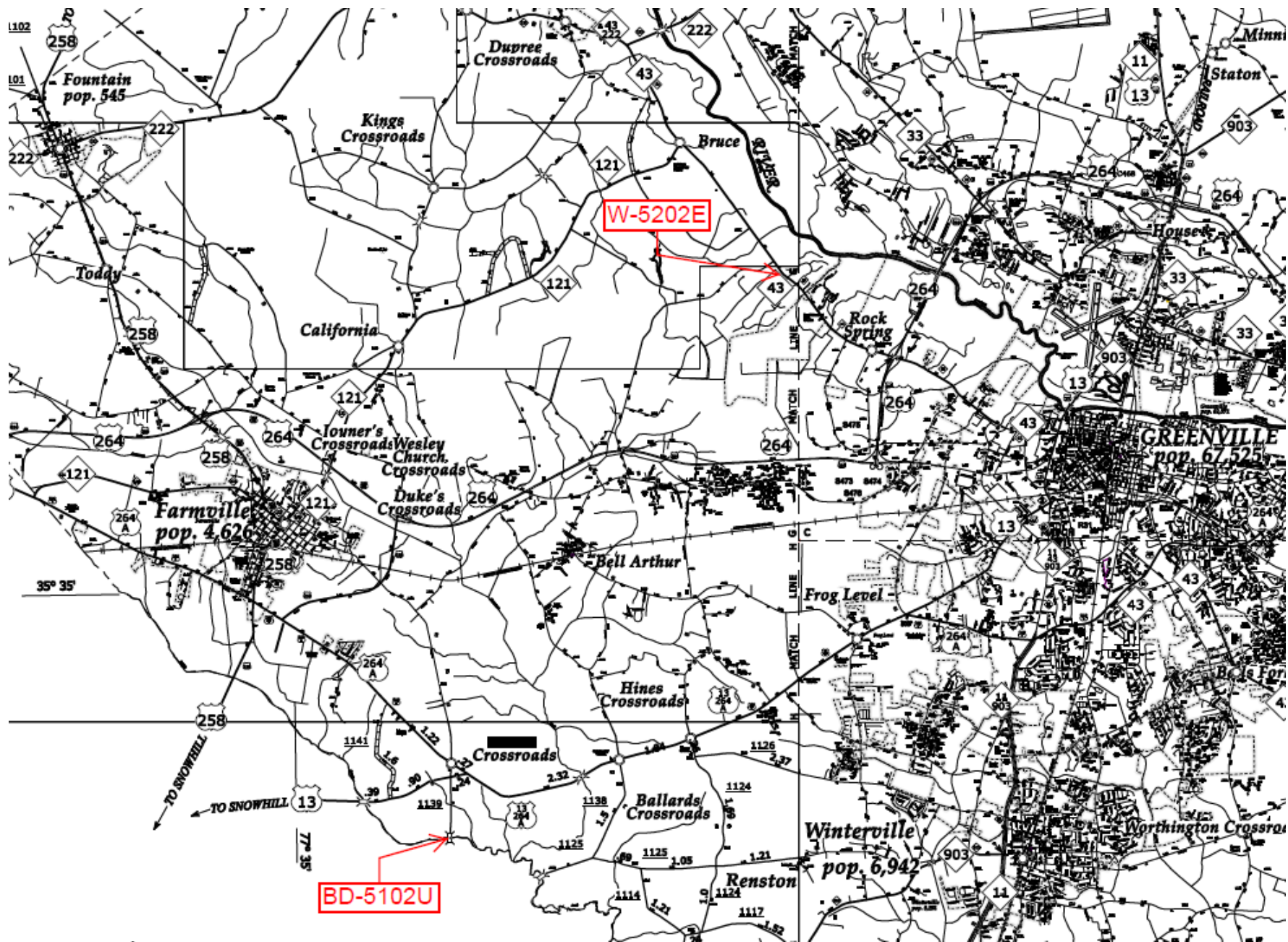

PITT COUNTY

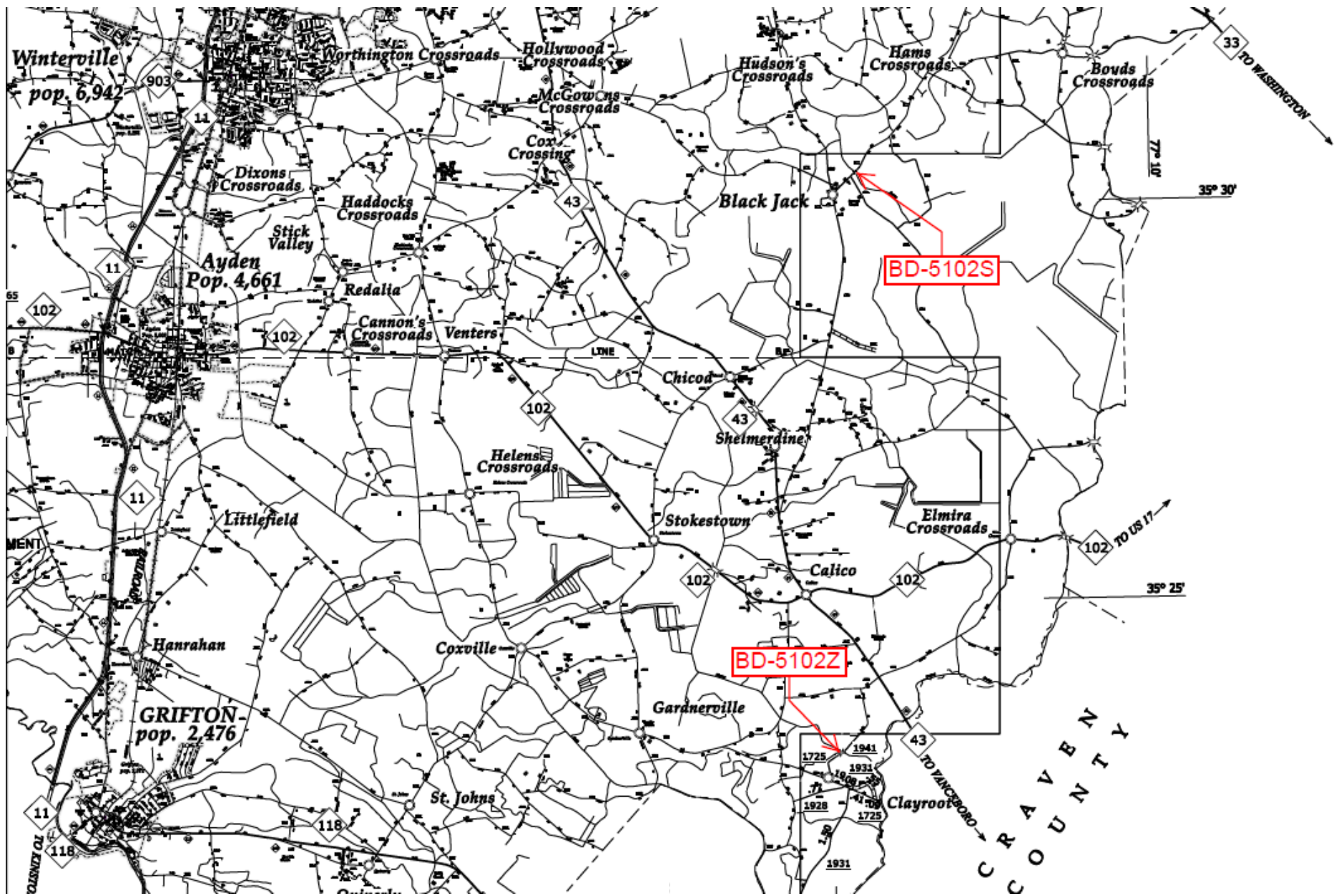

PITT COUNTY

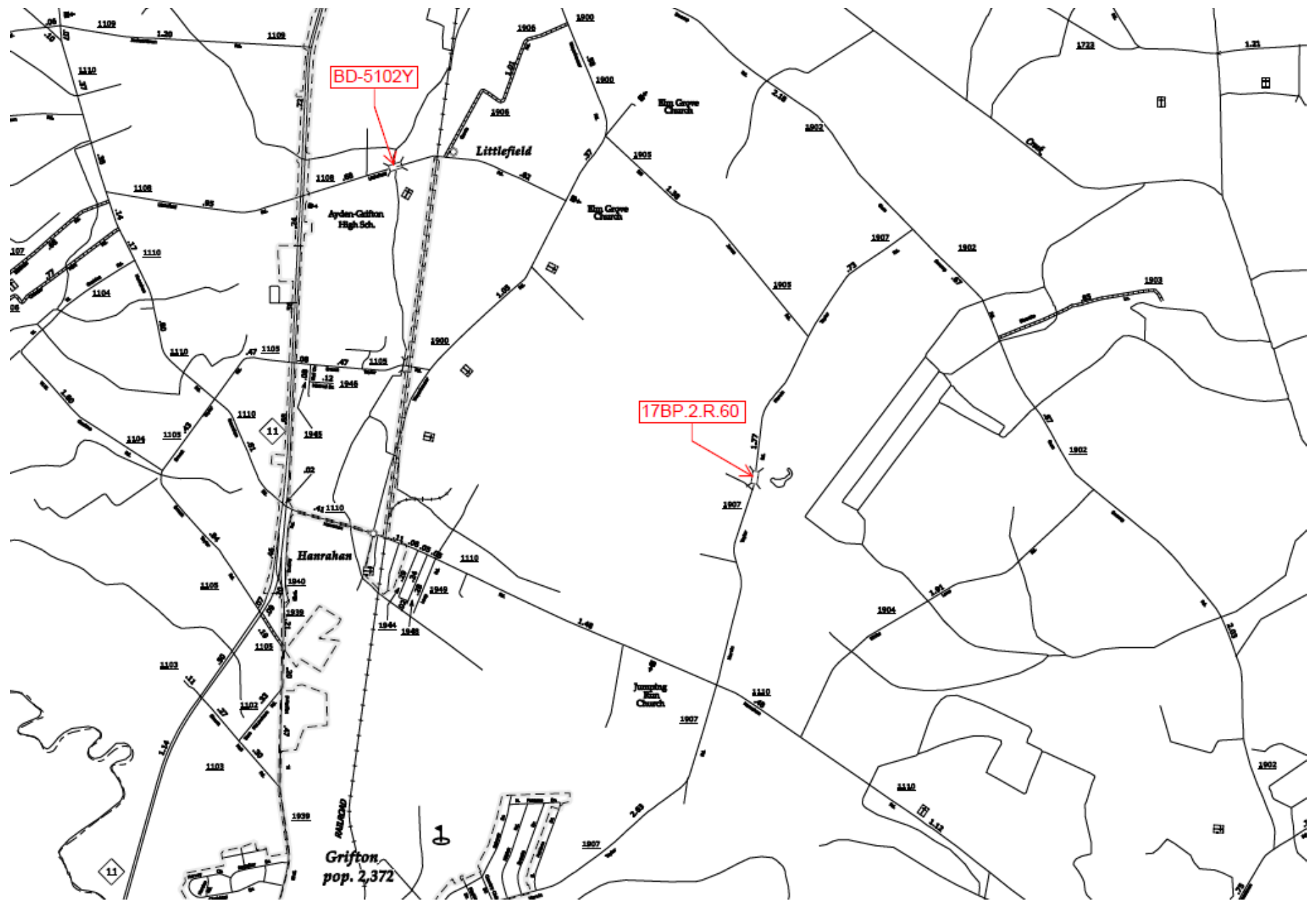

PITT COUNTY

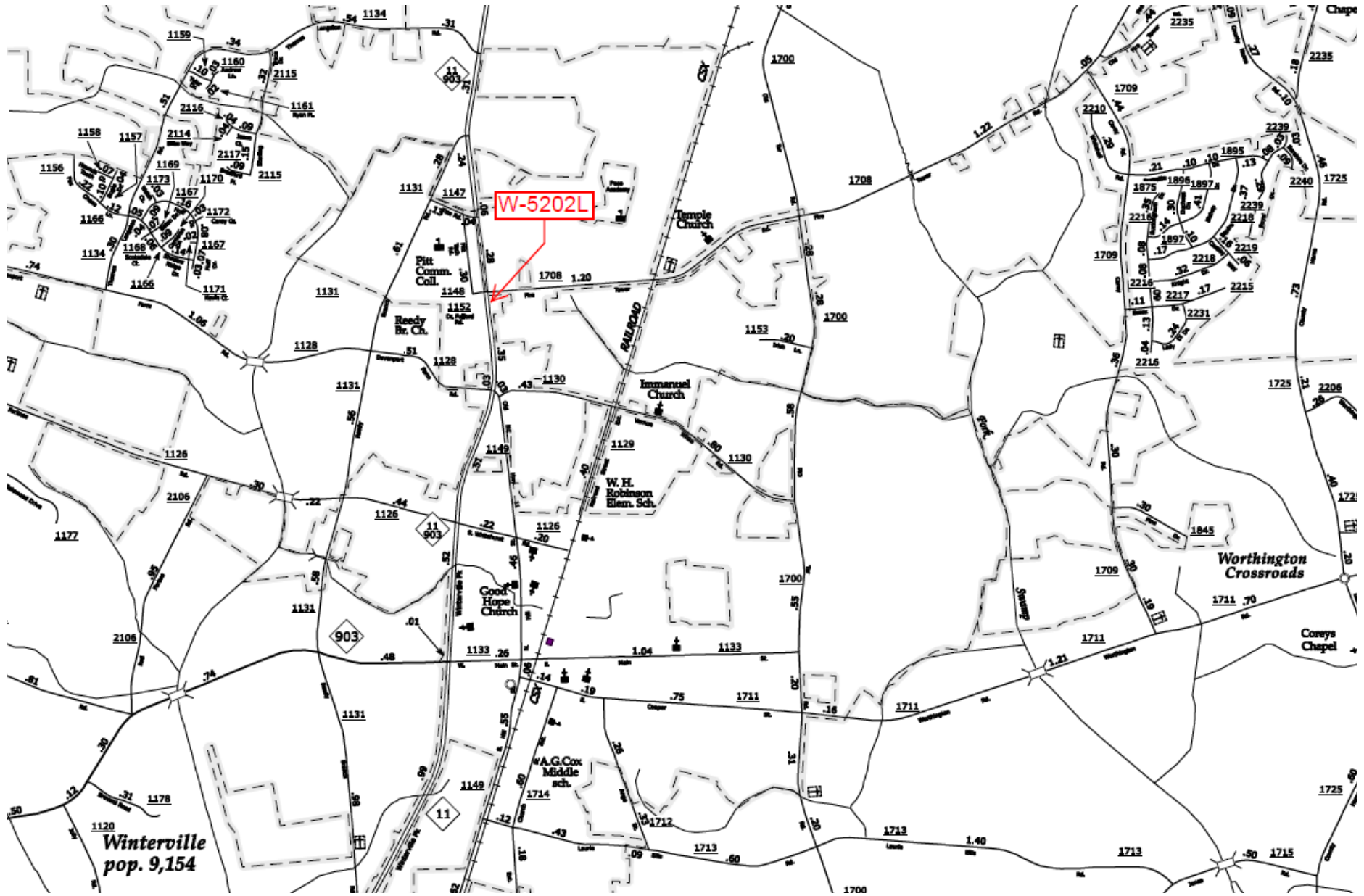

PITT COUNTY

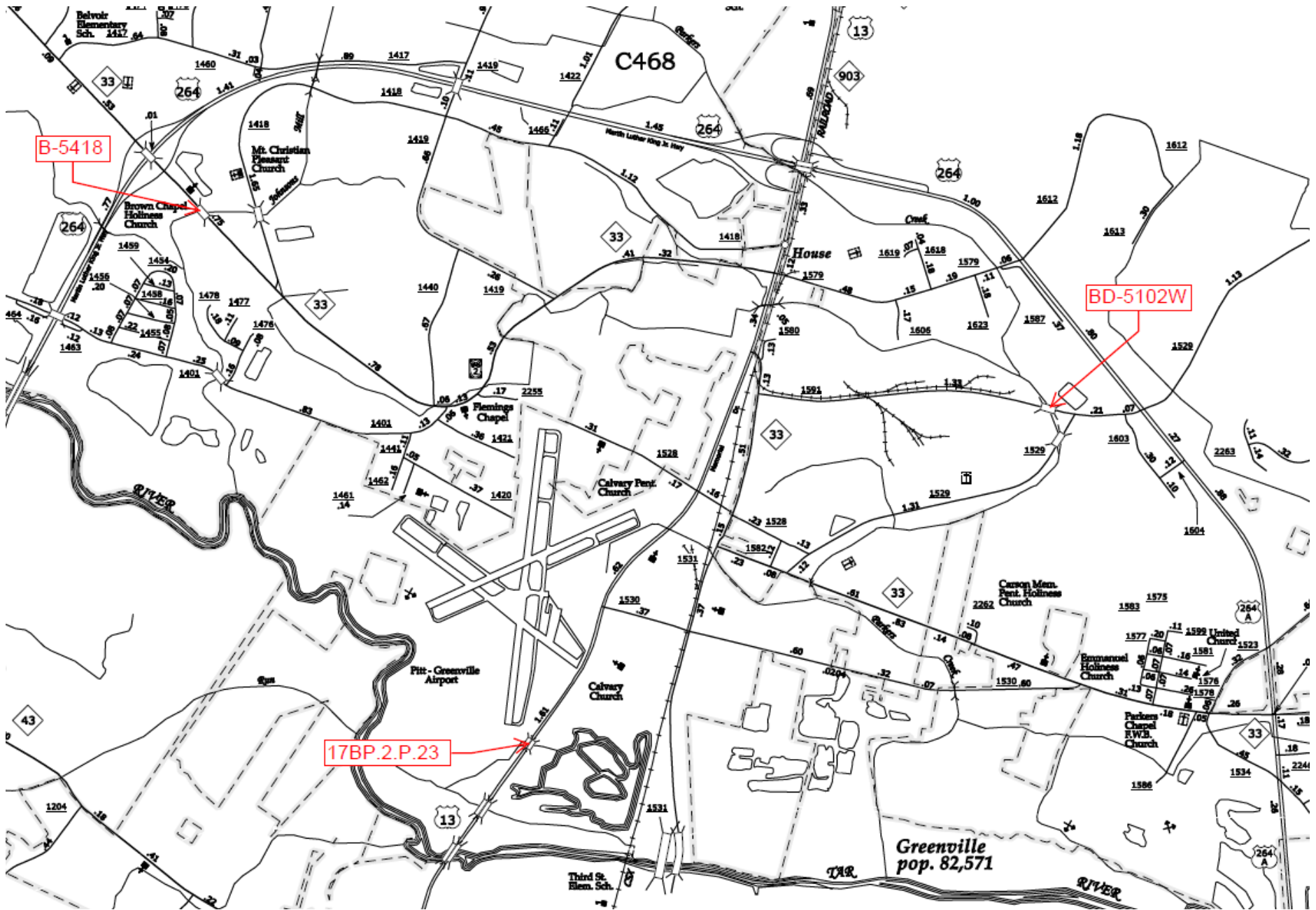

PITT COUNTY